

COGNOS RAW: REPORT STUDIO

Disclaimer: The below document is meant to assist users with the basic tasks of creating a report, adding filters, and general formatting. This may be used in conjunction with the [On Demand Training Video: Webinar – Cognos RAW Report Studio](#). Any questions should be submitted to the [Support Center](#).

Create a New Report

Click the **plus sign** in lower left corner.

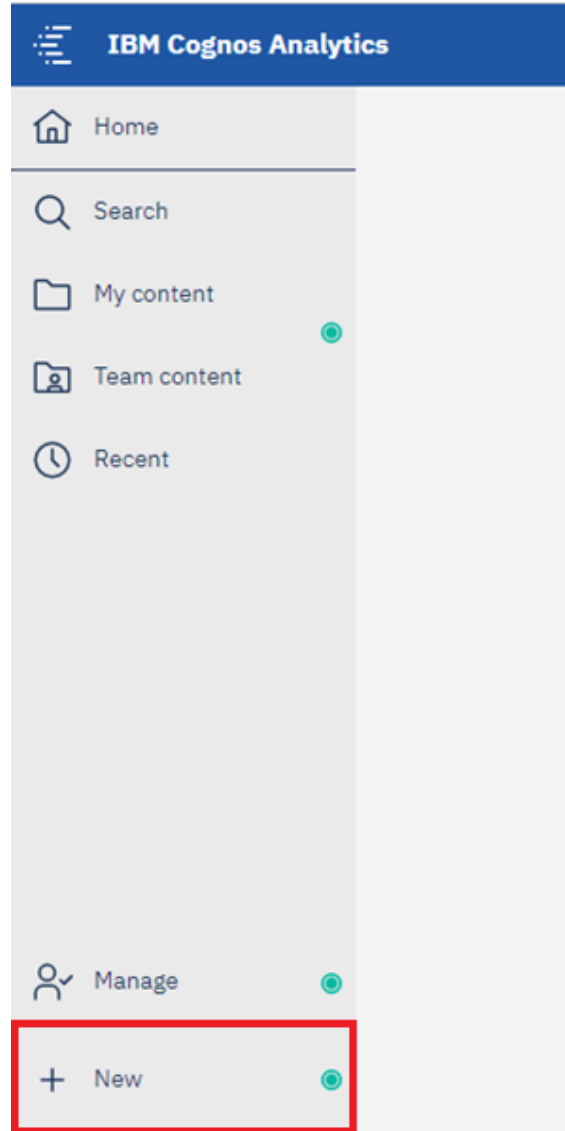

Click **Report**.

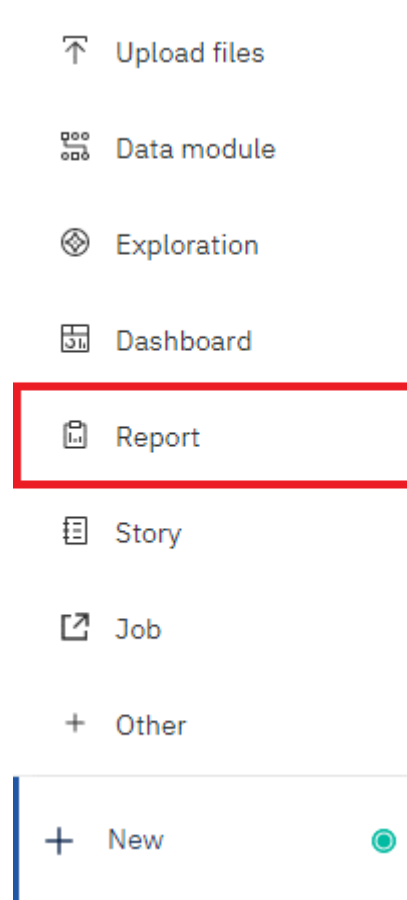

The Templates and Themes page opens.

Select the **Blank** report.

Click **OK**.

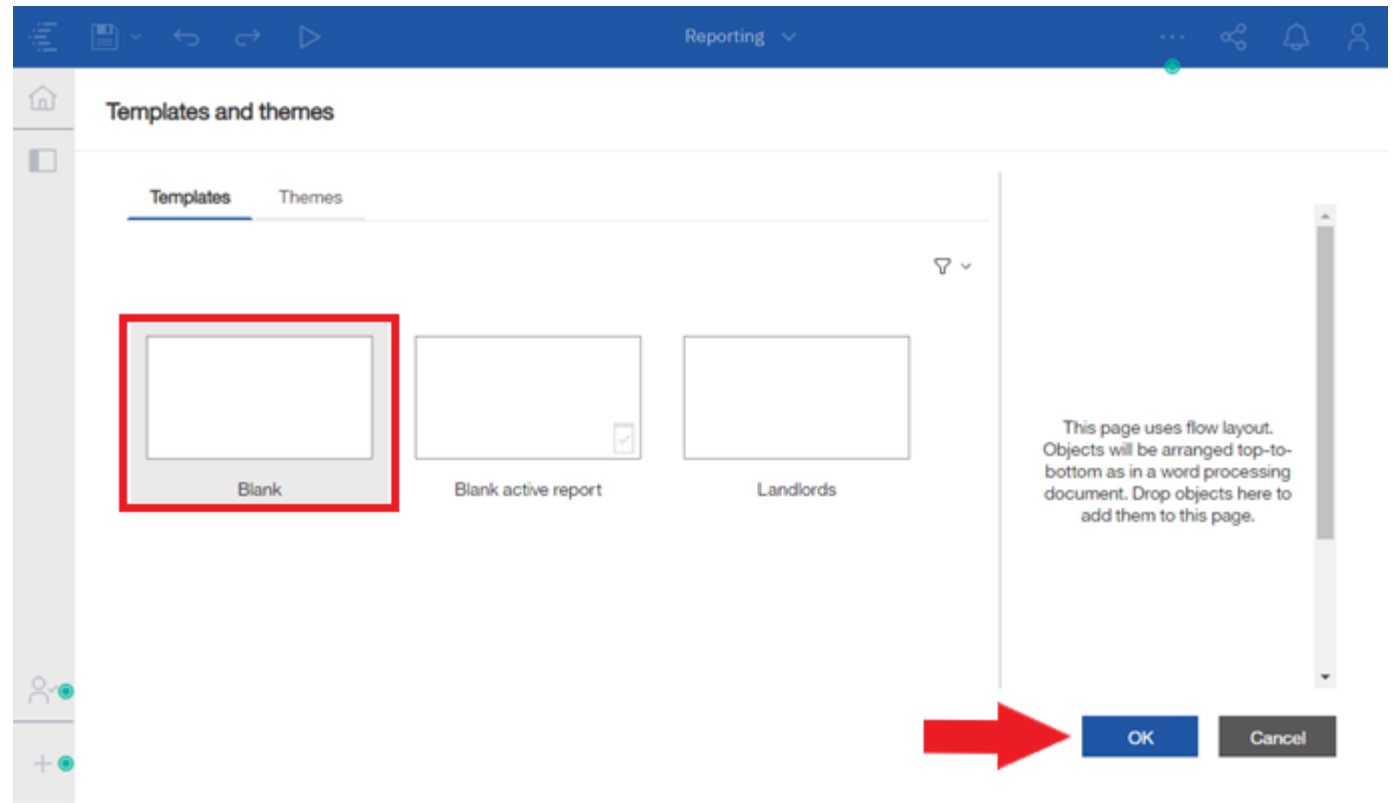

From the center pane, click the **Plus** icon.

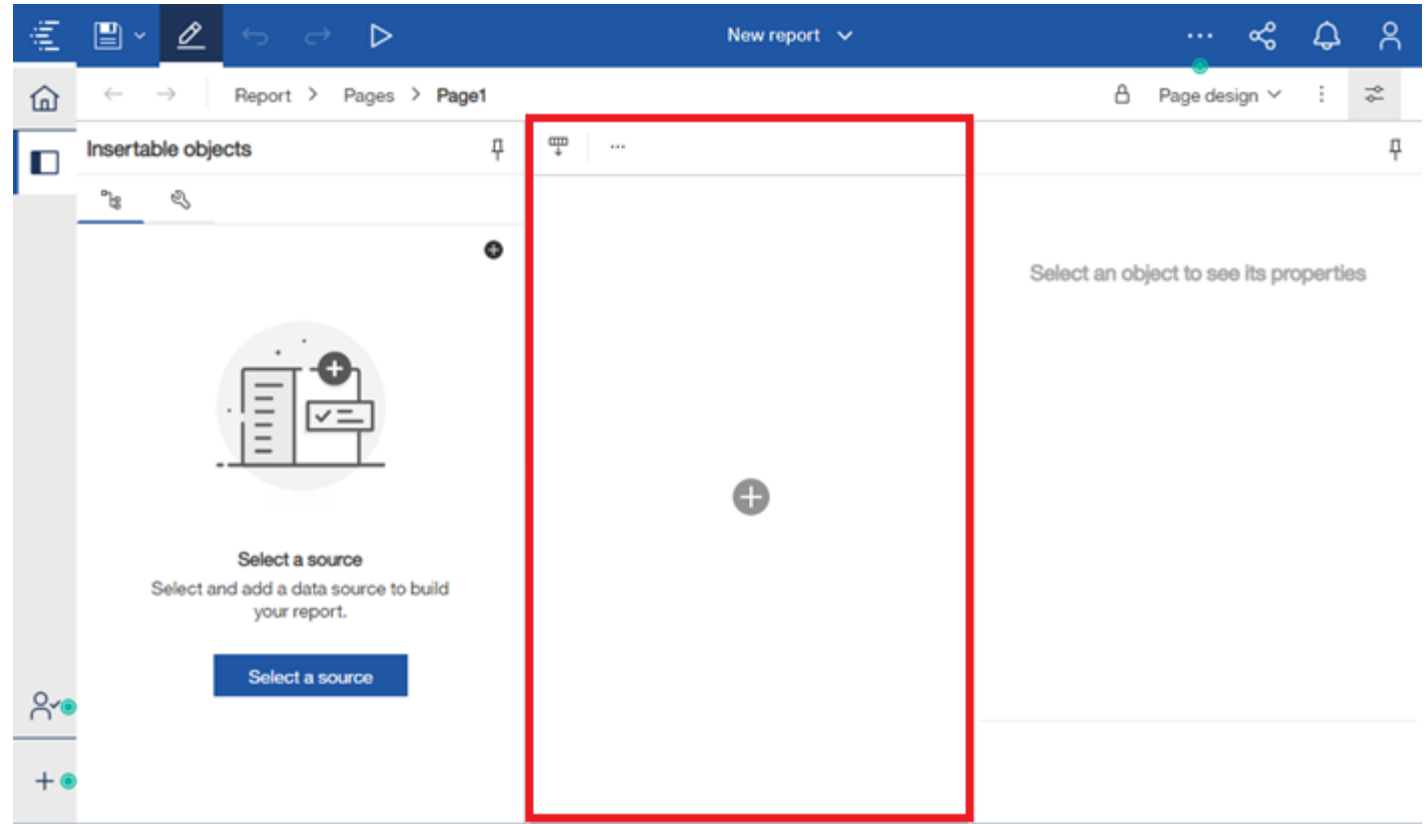

Six available report types appear.

Select **List**. This is comparable to Query Studio reports.

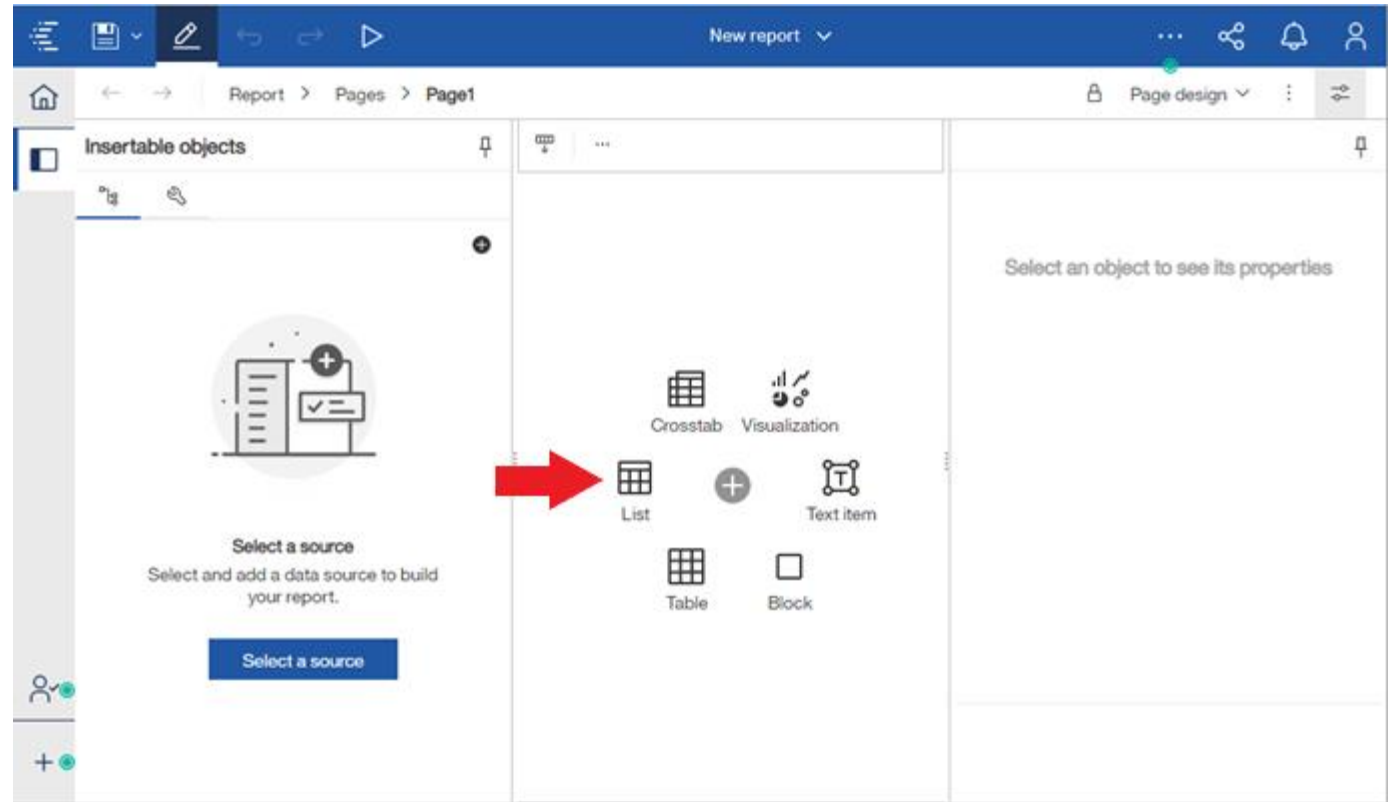

A pop-up window appears requesting the **Object and Query name**.

Accept the default names for both Name and Query Name.

Click **OK**.

Note: Uncheck the 'Show this dialog in the future' box if always accepting the default names.

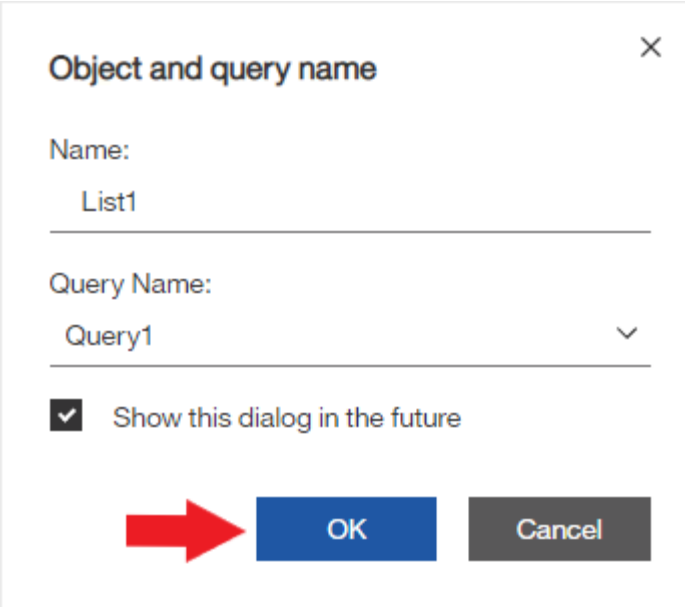

Object and query name

Name:
List1

Query Name:
Query1

Show this dialog in the future

OK Cancel

From the left pane, click **Select a Source**.

The screenshot shows the Power BI report designer interface. On the left, the 'Insertable objects' pane is highlighted with a red border. It contains a 'Select a source' button and the text 'Select and add a data source to build your report.' In the center, a table is being created, with a blue box containing the text 'Drop items here to create new columns'. On the right, the 'List' table is visible, showing various properties and values.

CONDITIONAL	
Conditional styles	
Style variable	
Render variable	
No data contents	No Data Available

DATA	
Grouping & sorting	
Query	Query1
Rows per page	
Master detail relationships	Unavailable
Suppression	
Properties	
Share result set	No

GENERAL	
Contents height	Minimal
Column titles	At start of list
Scrollable area height	

A pop-up window appears.

Select **WPPI Raw** from the options menu.

The window updates indicating *No data matched your search...*

Click **Open**.

